

Rutland County Council

Catmose, Oakham, Rutland, LE15 6HP

Telephone 01572722577 Email democraticservices@rutland.gov.uk

Ladies and Gentlemen,

A meeting of the **RUTLAND COUNTRYSIDE ACCESS FORUM** will be held in Via Zoom - <https://us06web.zoom.us/j/82859605805> on **Wednesday, 13th March, 2024** commencing at 2.00 pm when it is hoped you will be able to attend.

Recording of Council Meetings: Any member of the public may film, audio-record, take photographs and use social media to report the proceedings of any meeting that is open to the public. A protocol on this facility is available at www.rutland.gov.uk/my-council/have-your-say/

Yours faithfully

Mark Andrews
Chief Executive

A G E N D A

1) WELCOME & APOLOGIES

2) DECLARATIONS OF INTEREST

3) MINUTES OF PREVIOUS MEETING

To confirm the Minutes made at the meeting of the Forum held on 6th September 2023.
(Pages 3 - 6)

4) QUESTIONS FROM MEMBERS OF THE PUBLIC

The public will be able to ask questions on the business at the discretion of the Chair, subject to a time limit of 3 minutes per person.

5) MEMBERSHIP OF THE FORUM

To receive a written report from the Chair of the Forum.
(Pages 7 - 8)

6) MILES WITHOUT BARRIERS

To receive a written report from John Law.
(Pages 9 - 10)

7) COUNTRYSIDE ACCESS FORUM LOGO

To receive a written report from the Chair of the Forum.
(Pages 11 - 12)

8) COUNTRYSIDE FOR ALL

To receive a written report from John Law.
(Pages 13 - 14)

9) DEVELOPMENT SITES

To receive a written report from the Chair of the Forum.
(Pages 15 - 18)

10) ANY URGENT BUSINESS

11) DATE OF NEXT MEETING

Wednesday, 23rd October 2024 at 2pm (Provisional)

---oOo---

DISTRIBUTION

MEMBERS OF THE RUTLAND COUNTRYSIDE ACCESS FORUM

1.	Councillor S Harvey
2.	Councillor S McRobb
3.	Mr R Bancroft
4.	Mr R Brett
5.	James Buchanan
6.	William Cross
7.	Rosemary Harris
8.	William Kirstein
9.	Mr J Law
10.	Mr R Linford (Chair)
11.	Sheila Storer
12.	John Williams

OFFICERS:

13.	Stuart Crook	Highways Asset Management and Policy Manager
-----	--------------	--

Quorum: 5

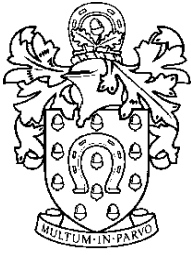

Rutland County Council

Catmose Oakham Rutland LE15 6HP

Telephone 01572 722577 Email governance@rutland.gov.uk

Minutes of the **MEETING of the RUTLAND COUNTRYSIDE ACCESS FORUM** held via Via Zoom on Wednesday, 6th September, 2023 at 2.00 pm

PRESENT: Roger Linford (Chair)
John Law
Rosemary Harris
Councillor S Harvey
Councillor S McRobb
William Cross
Sheila Storer

OFFICERS PRESENT:	Stuart Crook	Highways Asset Management and Policy Manager
	David Ebbage	Democratic Services Officer
	Mark Young	Senior Facilitator – Neighbourhood Working

1 WELCOME & APOLOGIES

Apologies were received from William Kirstein, James Buchanan and Richard Brett.

2 APPOINTMENT OF CHAIR

Nominations were invited for the position of Chairman of the Rutland Countryside Access Forum for the Municipal Year 2023-24.

William Cross proposed, and this was seconded for Roger Linford to be Chairman to the Rutland Countryside Access Forum, there were no other nominations. Upon being put to the vote this was unanimously carried.

RESOLVED

That Roger Linford be **APPOINTED** Chairman of the Rutland Countryside Access Forum for the municipal year 2023-24

3 DECLARATIONS OF INTEREST

There were no declarations of interest.

4 MINUTES OF PREVIOUS MEETING

The minutes of the meeting held on the 8th March 2023 were considered and **AGREED** as a true record.

5 QUESTIONS FROM MEMBERS OF THE PUBLIC

There were no questions from members of the public.

6 MILES WITHOUT BARRIERS

John Law introduced the written report on Miles Without Barriers.

He informed Members regarding the Green Social Prescribing, at the previous Countryside Access Forum meeting, Rutland County Council staff were made aware again of the green social prescribing opportunities offered by walk leaflets and the Countryside for All leaflets. The Lincolnshire leaflets were available through the Lincolnshire Joint Local Access Forum. The Rutland leaflets were available from Stuart Crook. Although interest was shown at the time by Rutland County Council members of staff and the other contacts that were provided, there had been no requests for any of the leaflets.

Councillor Harvey agreed to pass on details of a contact who was part of the Primary Care Network Team to try and assist for the information to be shared. Councillor Harvey also felt it was worth to get in contact with Active Rutland since they took over GP referrals from April.

John also informed Members of the Draft Project Definition Document which was to help inform people of the degree of accessibility of Public Rights of Way in Rutland. This project aimed to identify physical barriers on the PROW network and provide an online map displaying routes with similar access standards.

The Chairman thanked John for the very comprehensive document but wanted to emphasise for users with limited mobility, bridleways have much to commend compared with footpaths as they would be style free.

William Cross suggested to help with getting information out to people was for a QR Code be set up on village noticeboards to direct anyone to the relevant information. Stuart Crook agreed with the proposal but made Members aware that the websites it would direct people to needed to be more of a finished product first.

John lastly informed Members of the draft synopsis for Miles Without Barriers which was to inform possible funding sources of the Forum aimed to do and see if they have an interest in funding the Miles Without Barriers project. The figure looked at for the project was £10k, this cost would be broken down in detail and would explain what was needed for the project to happen.

It was confirmed that the funding would be held by Rutland County Council on the Forum's behalf.

7 RUTLAND WATER

John Law introduced the written report on Rutland Water.

The survey for the Rutland Water Countryside for All leaflet, which was a route from Normanton to Sykes Lane, was undertaken by Stuart Crook and a member of the South Lincolnshire and Rutland Local Access Forum. The results of the survey the Rutland Water Countryside for All leaflet was produced.

The Local Access Forum raised money to train organisations in surveying routes to create Countryside for All route leaflets which two members of staff from the Rutland Water Nature Reserve were trained and they went on to produce the Rutland Water Nature Reserve Countryside For All leaflet.

Since the pandemic we were told by Anglian Water, further surveys would be undertaken to revise the two leaflets. We were also told that other routes had been surveyed around Rutland Water to create additional Countryside for All leaflets. Accessing these leaflets now had become difficult there had been no success with communication back from Anglian Water.

The Chair agreed to further contact Anglian Water to seek a response on the current situation of the leaflets.

8 COUNTRYSIDE ACCESS FORUM LOGO

John Law introduced the written report on the Countryside Access Forum Logo.

A new logo would help benefit the leaflets that are produced and for potential future members to join the forum.

It was confirmed by Stuart Crook that the Communications Team at Rutland County Council did not have the capacity to assist with a new logo for the forum.

Councillor Harvey agreed she would have discussions with officers outside of the forum at the potential route of apprentices for the Council who potentially could help with the production of a new logo.

9 FARM LAND CONSTRUCTIONS

John Law introduced the written report on Farm Land Constructions.

He informed Members that in February this year Natural England released their Guidance to help towns and cities turn greener with their web site. Whilst this was a step in the right direction for towns and cities, it does not appear to help rural areas.

John asked for the Forum's approval to work on a project with other local access forums where we may be able to persuade Government to listen to our concerns. With the CAF agreement I would pursue this matter with the CAF and the Lincolnshire Joint Local Access Forum and their Disability Subgroup. I would ask for input from members as the need arises and these maybe between Forum meetings.

Councillors Harvey and McRobb gave the latest timetable on the Local Plan for Rutland especially regarding Section 18 Consultation which was the next stage and felt the call for sites would be interesting for the Forum to look at once they are listed.

It was agreed that the Clerk would send the agenda link for the October Cabinet meeting to the forum members so they could access the Local Plan item. John would then come back with an updated framework before he was to work on the project.

10 ANY URGENT BUSINESS

There were no items of urgent business.

11 DATE OF NEXT MEETING

Wednesday, 13th March 2024.

---oOo---

Chairman closed the meeting at 3.20pm.

---oOo---

MEMBERSHIP OF THE FORUM

A number of members have not attended the meetings over the last two years. Clearly it is concerning with only having two meetings a year, if a meeting is non quorate. We need to be quorate to carry out our function. If members cannot attend they need to send in an apology for their absence.

ACTION: The secretary of the Forum is requested to remind those at the meeting of the rules in terms of attendance and email all who are not at the meeting the relevant rules.

This page is intentionally left blank

MEMBERSHIP OF THE FORUM

A number of members have not attended the meetings over the last two years. Clearly it is concerning with only having two meetings a year, if a meeting is non quorate. We need to be quorate to carry out our function. If members cannot attend they need to send in an apology for their absence.

ACTION: The secretary of the Forum is requested to remind those at the meeting of the rules in terms of attendance and email all who are not at the meeting the relevant rules.

This page is intentionally left blank

Agenda Item 7

RUTLAND COUNTRYSIDE ACCESS FORUM LOGO

Members of the Forum have had an input to the design of the logo. We now need a final agreement on what the logo should be, as the logo will be printed on the Exton Countryside For All leaflet. It will be also included on any letters sent out.

ACTION: Members present at the meeting to vote on adopting the latest design of the Logo

This page is intentionally left blank

COUNTRYSIDE FOR ALL LEAFLETS

RUTLAND WATER

A number of emails have been communicated with staff at Rutland Water, in relation to the out of date Countryside For All leaflets on their web site. It was a member of their staff that informed us that Rutland Water staff had carried out surveys during the pandemic with the aim of updating the current two leaflets and creating other Countryside For All leaflets.

Unfortunately Anglian Water have stated they will not be able to fund the reprinting of the leaflets at the moment. I feel that they need to update the leaflets in terms of accessibility prior to printing. Looking at their new web site both leaflets have now been removed. However, the Countryside For All map of the Rutland Water leaflet (has been placed on the new web site at <https://anglianwaterparks.co.uk/rutland-water-park/walking-relaxing>).

ACTION: Our Anglian Water Member, William Kirstein, of the Rutland Countryside Access Forum – Updates the Forum , in relation to what is happening to help people with limited mobility access the Nature Reserve and the other routes which were surveyed during the pandemic.

ACTION: An email to be sent to Discover Rutland in relation to the two Rutland Water Countryside For All leaflets informing them, that we have been informed that they are out of date.

EXTON

We have secured funding for the Exton leaflet. The leaflet will be updated and distributed in the coming weeks.

This page is intentionally left blank

DEVELOPMENT SITES

KETTON CEMENT

Stuart to provide an update.

DEVELOPMENTS WHICH TAKE UP A SIGNIFICANT AREA OF FARM LAND, WHICH ARE OUTSIDE THE CURRENT LOCAL PLAN

This was raised at the last meeting in relation to Natural England releasing their Guidance to help towns and cities turn greener with their <https://designatedsites.naturalengland.org.uk/GreenInfrastructure/Home.aspx> web site. Whilst this is a step in the right direction for towns and cities, it does not appear to help rural areas. Work on this item by the CAF is on hold at the moment.

OTHER PLANNING APPLICATIONS WHICH AFFECT THE PROW NETWORK

Stuart to provide an update

This page is intentionally left blank

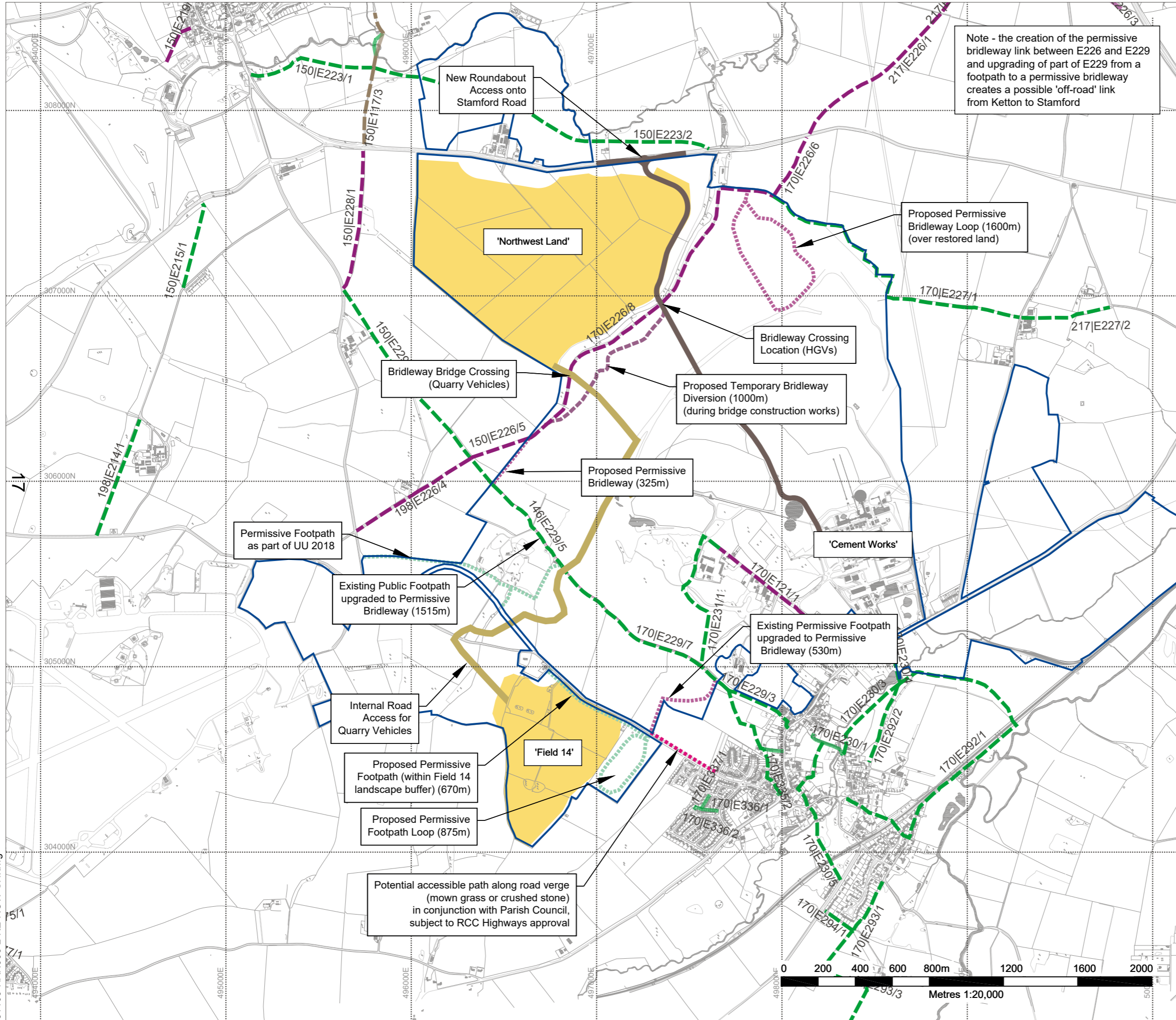

Note - the creation of the permissive bridleway link between E226 and E229 and upgrading of part of E229 from a footpath to a permissive bridleway creates a possible 'off-road' link from Ketton to Stamford

- Legend**
- Hanson Surface and Mineral Ownership
 - Proposed Mineral Extraction Areas
 - Proposed HGV Access Road
 - Proposed Quarry Vehicle Access Road
- Rights of Way**
- Public Footpath
 - Bridleway
 - Byway Open to All Traffic
- Proposed Rights of Way**
- Temporary Bridleway Diversion
- Permissive Routes**
- Proposed Permissive Footpath Routes
 - Proposed Permissive Bridleway Routes
- Other**
- Potential Access (with Parish Council and subject to RCC Highways Approval)

Summary of Additional Access	
1545m	Proposed Permissive Footpath Routes (x2)
1925m	Proposed Permissive Bridleway Routes (x2)
530m	Upgrade Permissive Footpath to Bridleway
1515m	Upgrade Public Footpath to Bridleway
1000m	Proposed Temporary Bridleway Diversion



SITE
Ketton Grange Top Quarry

PROJECT
Proposed Extensions

DRAWING TITLE
Proposed Public Access Summary

DATE
Nov 2023

REFERENCE
KE-ROW

SCALE
1:20,000 @ A3

STATUS
FINAL



231109-HAN006-L-KE-ROW-SH.dwg

This page is intentionally left blank